

Removing and installing rear shelf support

Special tools and workshop equipment required

- ♦ Lever -3409-

3409



W00-11118

- ♦ Torque screwdriver -VAG 1624-

Removing

- Remove the rear tray.
- Remove the lower C-pillar trim
- Chapter.

V.A.G 1624

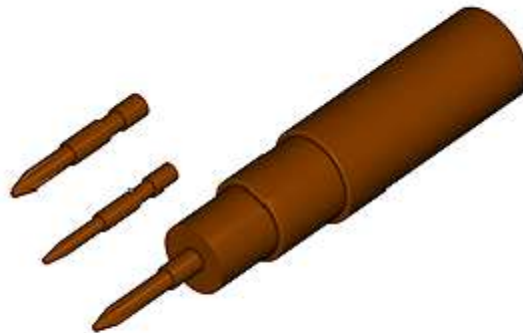

W00-11187

- Unscrew bolts -2- and -3-.
- Loosen the belt end anchor for the safety belt → **Chapter**.

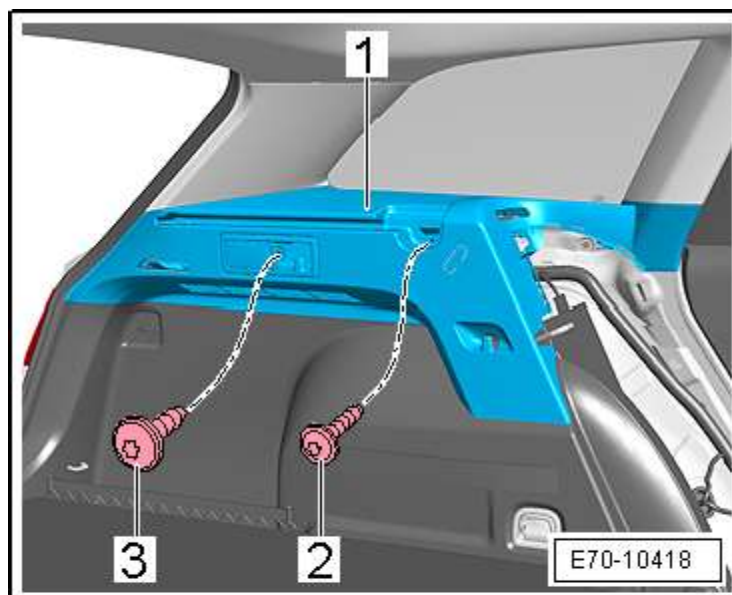

- Remove the luggage compartment lock -2- → **Chapter**.
 - With the aid of the lever -3409- loosen the trim -1-.
- Only for the left-hand side
- Disconnect 12 Volt socket.

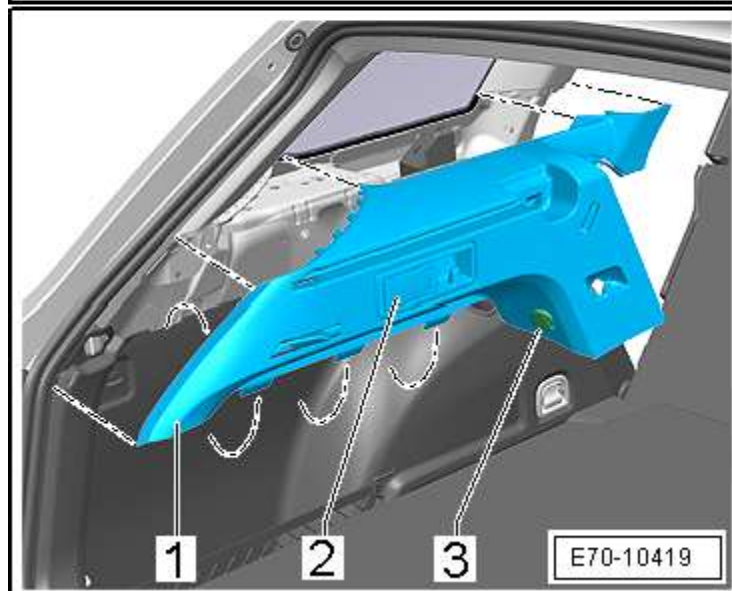

Installation

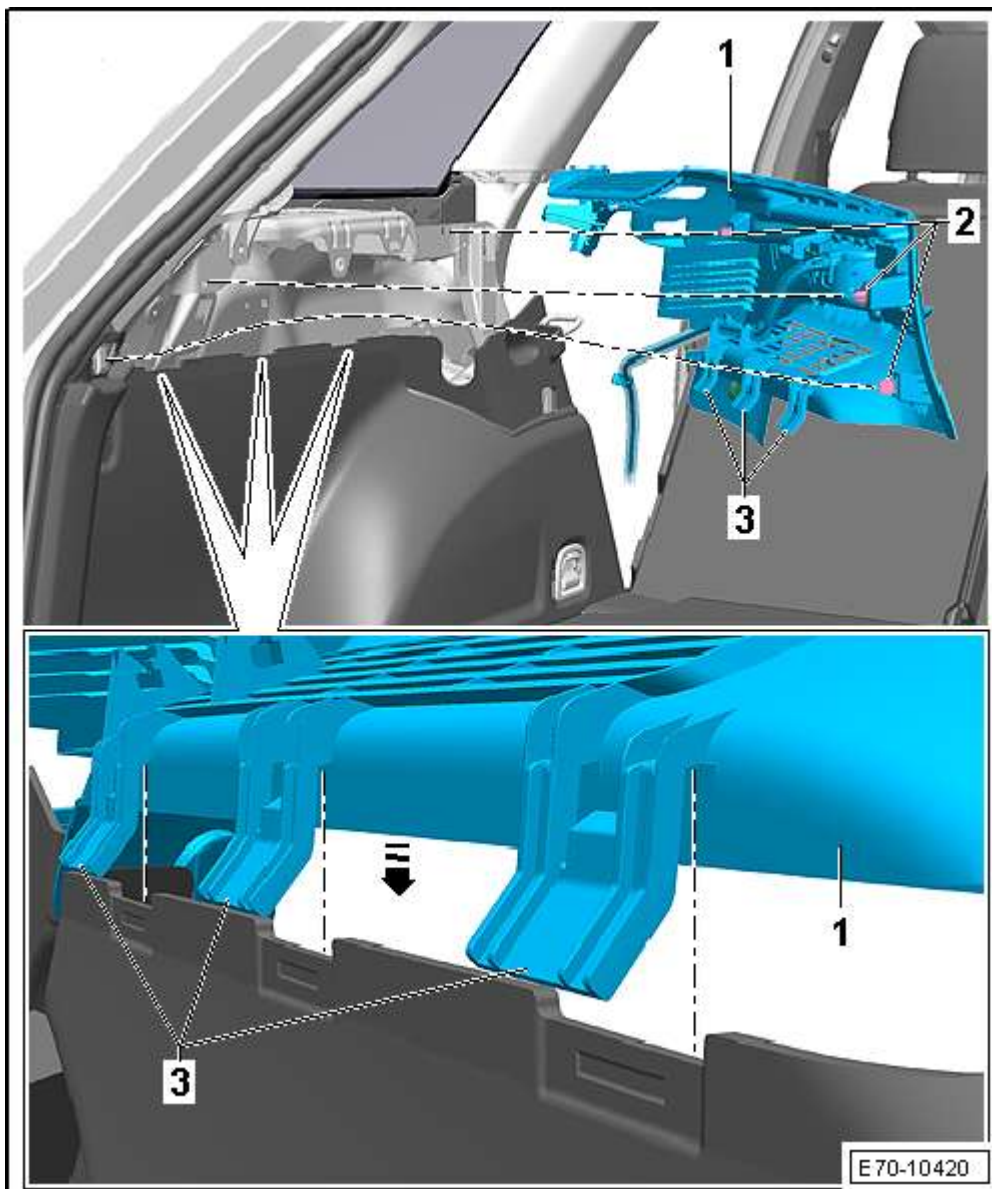

Installation is carried out in reverse order. The following should be taken into account:

- Attach tabs -3- to the mounting point as illustrated.
- Pull the sealing lip of the rear lid over the storage compartment mounting trim.



Note

Before inserting the trim, check the condition and the position of the clips and, if necessary, replace them or adjust when they are deformed.

Tightening torques

- ♦ → [Chapter „Assembly overview - rear shelf support“](#)