

03.06.2022

Copyright VW AG

Technical Service Handbook

ElsaPro transaction no.:

DMS order no.:

VIN:

Model year:

Sales code:

Model description:

Engine code:

Gearbox code:

Registration number:

Final drive code:

Username:

Service advisor name:

 According to the vehicle identification, the following filter criteria could not be filtered automatically in this contribution. Please observe the limits listed for this contribution!

VIN ranges	Production date
VSS__KM_MR000226 - 007184	-

#### Basic filtering of vehicle description

Brand	Model year	Sales model	Engine code	Gearbox code	Final drive code
S	2021	KM% - ---	%	%	%

**Service Campaign 90T5**  
Q-Service Packet VRD Light Formentor

**Transaction No.: 2065736/2**  
Release date 19-May-2022

 **Repair instructions**

## Notes

### Technical background

#### Various Control Units Affected

In some CUPRA Formentor vehicles within the range of specified VINs, as a quality improvement, work must be carried out on several control units.



#### Important:

**First check** if the affected vehicles still have pending service campaigns, such as 90Q7. Perform the pending campaigns in order of publication.

If **service campaign 90Q7** is still pending in the affected vehicles, **before** carrying out **service campaign 90T5**, service campaign 90Q7 must be applied.

### Remedy

Various control units must be reprogrammed in affected vehicles.

**Not all vehicles are affected by this Service Campaign.**

**All affected vehicles must be repaired during a visit to the workshop.**

Before carrying out any repairs, check with the “**Service Campaigns**” system in ElsaPro or Online Service whether the vehicle is affected by this Campaign and other Campaigns.

## Customer notification

**Contact the customers of the affected vehicles by telephone.**

**There is no plan to inform clients in writing.**

Make sure that all the vehicles affected are checked and repaired once the vehicle is taken to the workshop.

If this Campaign has not been carried out during a visit to the workshop, please inform the user about this immediately.

We would also ask you to inform your new and used vehicle department immediately, so that these vehicles can be inspected and repaired, instead of waiting for the moment of their sale.

## Warranty accounting instructions

End of the service campaign	The service campaign is in effect until <b>30.06.2027</b> , and will be closed on this date.
Fault code	<b>90T5</b>
Anomaly code	<b>0066</b>
Code of part removed	<b>000</b>
Repair code	According to Warranty Handbook 1 = Labour causing the anomaly 2 = Part causing the incident
Claim type	7-10 = Service Campaign performed on registered vehicle 7-90 = Service Campaign performed on unregistered vehicle
Criteria	See “ <b>Service Campaigns</b> ” in ElsaPro or Online Service <b>01</b> = Reprogramme OCU control unit <b>02</b> = Reprogramme the MIB control unit <b>03</b> = Reprogramme affected control unit

### Warning

**The indicated time units may vary from the Catalogue of Work Items in ElsaPro.**

<b>Criteria 01-03</b>	<b>27 06 89 99</b> Connect the battery charger	<b>10 TUs</b>
<b>Criterion 01 02</b>	<b>97 10 26 99</b> Reprogramme OCU control unit and reprogramme the MIB control unit ( <b>in parallel</b> )	<b>Max. 180 TUs</b>
<b>Criterion 03</b>	<b>01 50 26 99</b> Reprogramme control units (CAN)	<b>TUs according to protocol (max. 135 TUs)</b>

\* the task "connect battery charger" can only be settled once.

For other Campaigns to take into account: see "Service Campaigns" in ElsaPro or Service Online.

Note:

Within the scope of this service campaign, only the software of several control units is updated. **In the attached table ('SW\_90T5\_v\*'), you can check which updates are performed.**

In the diagnostics session, do not carry out other operations not related to this Service Campaign.

Work resulting from event entries or indications of the diagnosis equipment represents repair measures and must not be invoiced with this Service Campaign.

After reprogramming, it is not necessary to generate the Readiness code.

## Genuine parts

### Parts supply

For this Service Campaign, it is not necessary to supply the parts.

### Parts despatch control

It is not necessary to return the parts for this Service Campaign.



## Repair instructions

### Technical background

#### Various Control Units Affected

In some CUPRA Formentor vehicles within the range of specified VINs, as a quality improvement, work must be carried out on several control units.



#### Important:

**First check** if the affected vehicles still have pending service campaigns, such as 90Q7. Perform the pending campaigns in order of publication.

If **service campaign 90Q7** is still pending in the affected vehicles, **before** carrying out **service campaign 90T5**, service campaign 90Q7 must be applied.

### Check

If the vehicle does not appear as reviewed in the "Vehicle-specific information" (in Service Online or ElsaPro), check if **"90T5 performed"** has been written in the Digital Maintenance Plan or in the Maintenance Plan. If the note does not exist, **carry out the appropriate tasks according to the Work Instructions.**

### Control

Verification of the tasks (criteria) – See ElsaPro or Online Service / Service Campaigns

Criterion 01	Reprogramme OCU control unit
--------------	------------------------------

<b>Criterion 02</b>	Reprogramme MIB control unit
<b>Criterion 03</b>	Reprogramme and configure control units (CAN)

## Genuine parts

## Tools

Consult the special tools, testing and measuring equipment and auxiliary devices necessary in the Repair Manual.

## Work

**Follow the order established in criteria 01, 02, 03. Start the reprogramming of the OCU control unit. In parallel, during the first update, continue with the update of the MIB unit. Once both updates are complete, continue with the update via CAN.**

### Criteria 01 - 03 Connect the battery charger and reprogramme the control units

Requirements for reprogramming the various control units:

<b><u>ODIS Service</u></b>	Unit updated to the latest available version <b>(at least ODIS 9.1.0 with data version 2.23.1)</b>
----------------------------	--

- The resting voltage of the vehicle must be at least 12.5 V during the reprogramming process. Connect the vehicle battery to an external electrical power supply. You will find more information on this in "Precision maintenance".
- During reprogramming, disconnect all unnecessary power consumers (ventilation, seat heating, interior lighting).
- During the reprogramming of the different control units, make sure that no electromagnetic source (mobile or DECT cordless phones) is operated inside or in the immediate vicinity of the vehicle.
- To reprogramme (flash update) control units, use diagnosis interface VAS 6154A (WLAN radiocommunication head) exclusively in USB mode, as it provides very high transmission stability.
- If installed, remove the hotfix file from the diagnostics equipment, as otherwise entries may be recorded in the event memory during use (only if necessary).

### Reprogramming the Affected Control Unit

Connect the online diagnostics equipment to the vehicle diagnosis connection and to the workshop server.

Before connecting the USB cable, remove the diagnostics unit radio communication terminal!

If a radiocommunication head that is already connected is used for diagnosis, observe the steps below in the specified sequence:

- Switch on ignition.
- Place the lever in position P (only with automatic gearbox / DSG).
- Turn on the hazard warning lights.



#### **Note:**

Before starting the reprogramming, always turn the ignition on and off.

Bear in mind that in vehicles equipped with the "Keyless Access locking and starting system" (KESSY), the ignition key must be inserted into its socket.

**Note:**

Before starting the reprogramming, activate the hazard warning lights to ensure CAN communication at all times

**Criterion 01: Reprogramme the OCU control unit:****Note:**

To perform this update, it is necessary to use the VAS 6154 or VAS 6154 A tool.

Reprogramme the affected control unit using the ODIS Service diagnosis system, at the following path:

Software version management >> Adapt software >> 1. Update software using action code

Use action code “ **35BF** ”.

**Whilst OCU control unit is being updated, update the MIB unit in parallel (at the same time), continue with criterion 02.**

**Criterion 02: Reprogramme the MIB control unit in parallel to the OCU control unit****Warning:**

**See the SEAT Repair Manual to carry out the procedures correctly and for the use and reference of the tools and equipment to use.**

**Premises for applying the repair process:**

A) The unit must have stable operation.

B) Inform the customer in advance that when carrying out the software update for the radio and navigation system, the following circumstances will occur:

- The user settings will be reset to the default settings.
- All stored radio stations and telephone connections will be lost. The radio stations and telephone connections must then be saved again.

**USB creation process:****Warning:**

**Do not place an order with the original spare parts department using the part reference mentioned below, as during the process described below in this service campaign, it will be you (the SEAT service) that creates the required USB.**

Update the software of the electronics control unit. To do so, create the USB using the SD Creator program, with one of the following Part and SW Codes, depending on the MIB original part reference.

List of USB part codes, infotainment equipment references and software version:

USB Part Code	Original Part Reference	Software Version (old)	New part reference	Software Version (new)
5FA 919 360 S	5FA 035 862 B 5FA 035 862 C	1672	5FA 035 862 K 5FA 035 862 L	1896

**Warning :**

The software versions indicated in the attached table correspond to the current versions on the launch date of this service campaign. There may be some discrepancies due to possible later updates. The version indicated in the column, "Software version (new)", or later must be used.

- Identify the USB with the corresponding reference:

- **5FA 919 360 S** with **SW 1896** for **original part references 5FA 035 862 B** and **5FA 035 862 C**.

**Note:**

For more information about SD Creator, see **service notification 2064554/\***.

**Software update procedure:**

For more information about the MIB update, see **service notification 2063010/\***.



**Note:**

If you are experiencing problems before doing the flash update of the MIB and it freezes on the welcome screen, disconnect a battery terminal and reconnect it. Make sure there is no update in progress before disconnecting the battery terminal.

**Criterion 03: Reprogramme and configure the various control units via CAN**

Reprogramme the affected control units using the ODIS Service diagnosis system, at the following path:

Software version management >> Adapt software >> 1. Update software using action code

Use action code "**35BC**".

After completing the reprogramming of the units via CAN, carry out an adaptation of the Vehicle Key Management System (VKMS) and an activation of functions via codes.

**Vehicle Key Management System (VKMS) adaptation procedure:**

Carry out the test "0025-VKMS Functions -> Adapt VKMS".  
In the "Test plan" mode (see Figure, highlighted in red) select the "Select own test..." function (see Figure, highlighted in red).

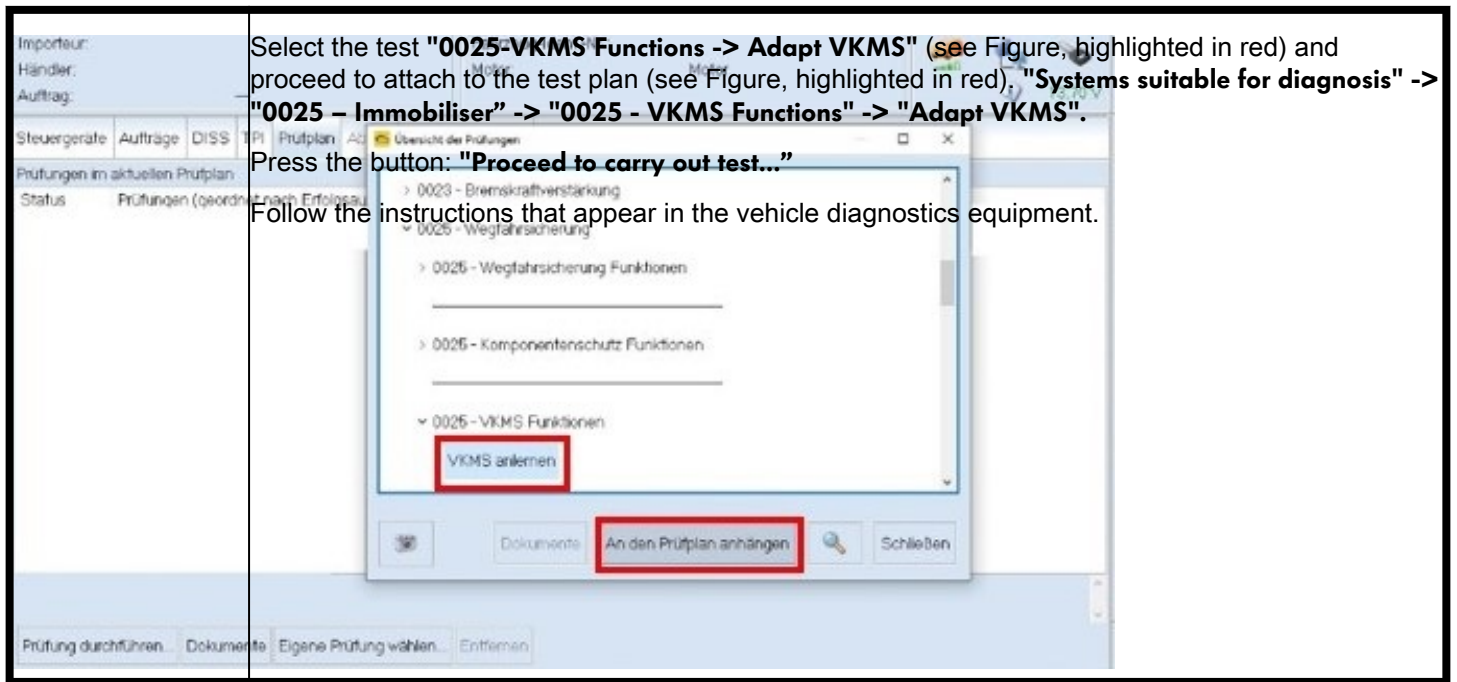

The predictive data of the route must be activated with the following FM CODE:

**FMVRDKLKMPFSFS**

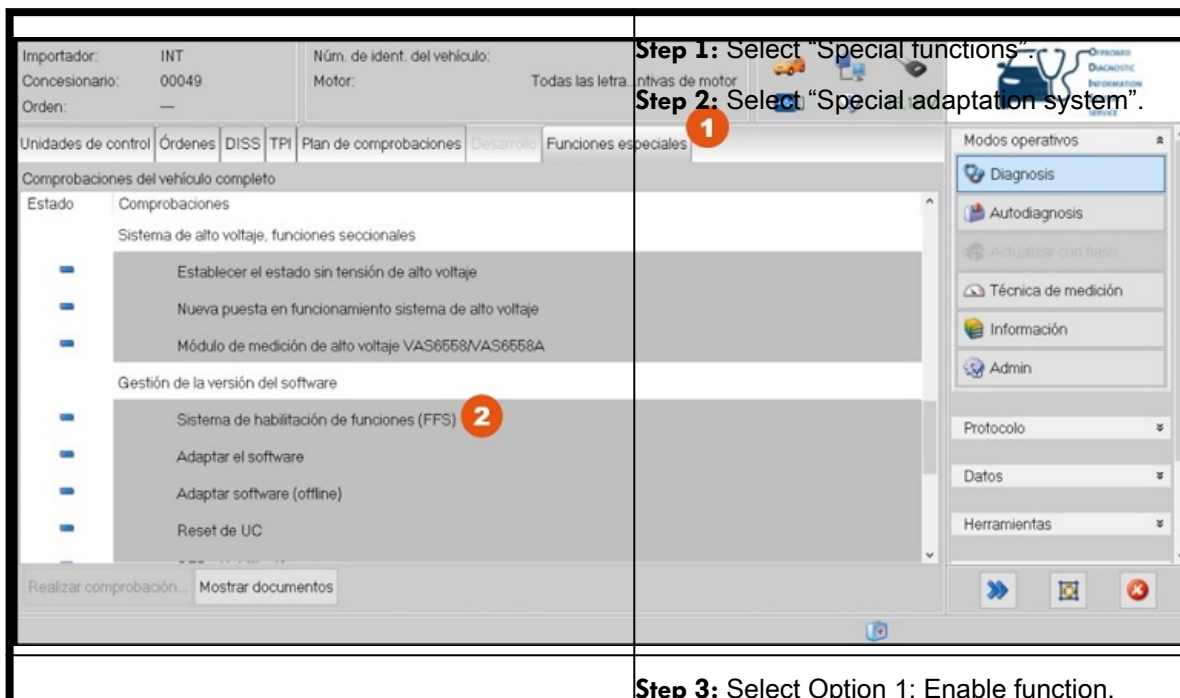

Importador: INT	Núm. de ident. del vehículo:	Todas las letras		13.18 V	
Concesionario: 00049	Motor:				
Orden: —					

Unidades de control | Ordenes | DISS | TPI | Plan de comprobaciones | **Desarrollo** | Funciones especiales

ElectronicsRepairService (ERS) -> FunctionOnDemand (FOD)  
[de\_DE]Hinweis  
[de\_DE]Dieses Programm unterstützt Sie beim Freischalten bzw. Wiederherstellen von Funktionen (Software als Produkt - SWaP).  
Sie benötigen hierzu aus der Lizenz:  
• Aktivierungs-Code  
• Aktivierungs-Nummer  
• Aktivierungs-Pin  
Wählen Sie bitte aus:  
1. Funktion Freischalten  
2. Funktion Wiederherstellen

[de\_DE]- 1 -

[de\_DE]- 2 -

Descripción de la función

Ayuda

Cancelar comprobación

Modos operativos  
**Diagnos**  
Autodiagnos  
Actualizar con flash  
Técnica de medición  
Información  
Admin  
Protocolo  
Datos  
Herramientas

Ejecución de la comprobación

Importador: INT	Núm. de ident. del vehículo:	Todas las letras		13.18 V	
Concesionario: 00049	Motor:				
Orden: —					

Unidades de control | Ordenes | DISS | TPI | Plan de comprobaciones | **Desarrollo** | Funciones especiales

ElectronicsRepairService (ERS) -> FunctionOnDemand (FOD)  
[de\_DE]Hinweis  
[de\_DE]Geben Sie bitte den Aktivierungs-Code ein:

REFUNACCD131

aplicar

Ayuda

Cancelar comprobación

Modos operativos  
**Diagnos**  
Autodiagnos  
Actualizar con flash  
Técnica de medición  
Información  
Admin  
Protocolo  
Datos  
Herramientas

Ejecución de la comprobación

Step 4: Enter activation code:  
**FMVRDKLKMPSFS**



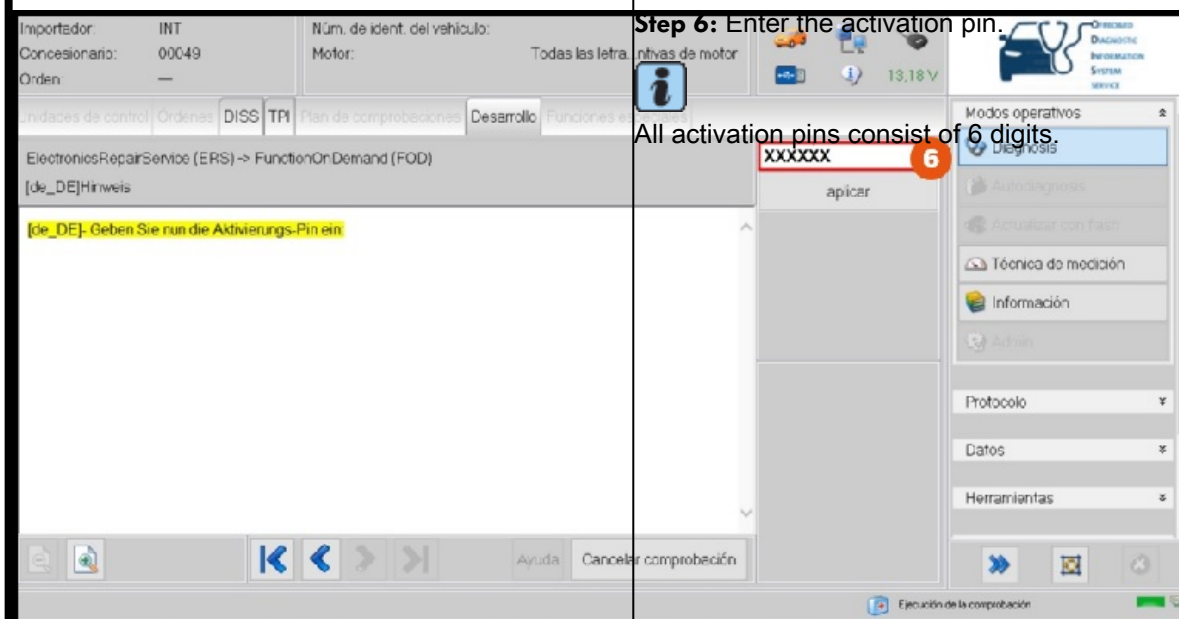
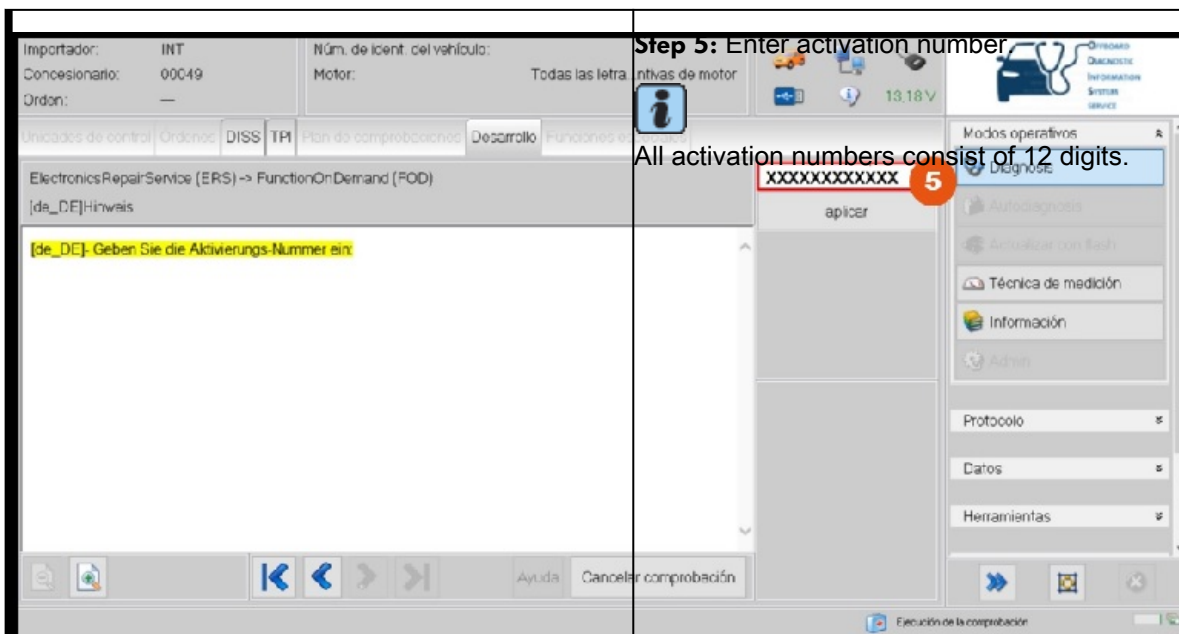

<p>Importador: INT Concesionario: 00049 Orden: —</p> <p>Núm. de ident. del vehículo: Motor: Todas las letras</p> <p>ElectronicsRepairService (ERS) -&gt; FunctionOnDemand (FOD) [de_DE]Hinweis</p> <p><b>7</b></p> <p>Aktivierungs-Code: REPFUNACCD131 Aktivierungs-Nummer: 969T3X873PA4 Aktivierungs-Pin: 586562</p> <p>Ist die Eingabe korrekt?</p>	<p><b>Step 7:</b> Check the information entered matches the information provided.</p> <p><b>Step 8:</b> Select: <b>Yes</b></p> <p>Each license can only be used once!</p>
<p>Importador: INT Concesionario: 00049 Orden: —</p> <p>Núm. de ident. del vehículo: Motor: Todas las letras</p> <p>ElectronicsRepairService (ERS) -&gt; FunctionOnDemand (FOD) USER-ID/LOGIN</p> <p>A continuación se transmiten los datos online. Para ello hay que establecer una conexión.</p> <p>- Utilice el hardware correspondiente para conectar el comprobador.</p> <p>- A continuación introduzca su <b>nombre de usuario</b> y su <b>contraseña</b>. Listo/Continuar</p>	<p><b>Step 9:</b> Enter Geko username and password. Select: <b>Apply</b></p>

Importador: INT

Concesionario: 00049

Orden: —

Núm. de ident. del vehículo:

Motor: Todas las letras

13.06 V

Indicadores de control

Ordenes

DISS

TPI

Plan de comprobaciones

Desarrollo

Funciones especiales

ElectronicsRepairService (ERS) -> FunctionOnDemand (FOD)

[de\_DE]Freischaltung aktivieren

[de\_DE]Die FunktionsFreiSchaltung für das Steuergerät Interface da diagnosis para bus de datos wird durchgeführt.

- Bitte warten Sie...

Modos operativos

Diagnosis

Autodiagnos

Actualizar con flash

Técnica de medición

Información

Admin

Protocolo

Datos

Herramientas

Ayuda

Cancelar comprobación

Ejecución de la comprobación

wait for the program to indicate the following steps.

Importador: INT

Concesionario: 00049

Orden: —

Núm. de ident. del vehículo:

Motor: Todas las letras

13.06 V

Indicadores de control

Ordenes

DISS

TPI

Plan de comprobaciones

Desarrollo

Funciones especiales

ElectronicsRepairService (ERS) -> FunctionOnDemand (FOD)

[de\_DE]Status FS-Ds ECUKOM

[de\_DE]Die FunktionFreiSchaltung ist erfolgreich durchgeführt worden.

Folgende Funktionen sind freigeschaltet:

FS-ID: 10000300

Funktion: MKE - Sistema de detección del cansancio

Status: freigeschaltet

FS-ID: 10000100

Funktion: GRA (remote from Gateway)

Status: freigeschaltet

FS-ID: 10000300

Funktion: MKE - Sistema de detección del cansancio

Status: freigeschaltet

FS-ID: 10000100

Funktion: GRA (remote from Gateway)

Status: freigeschaltet

FS-ID: 10020E00

Funktion: Luz ambiental paquete de colores ampliado

Status: freigeschaltet

FS-ID: 10020E00

Modos operativos

Diagnosis

Autodiagnos

Actualizar con flash

Técnica de medición

Información

Admin

Protocolo

Datos

Herramientas

Ayuda

Cancelar comprobación

Ejecución de la comprobación

Select: Ready / Continue

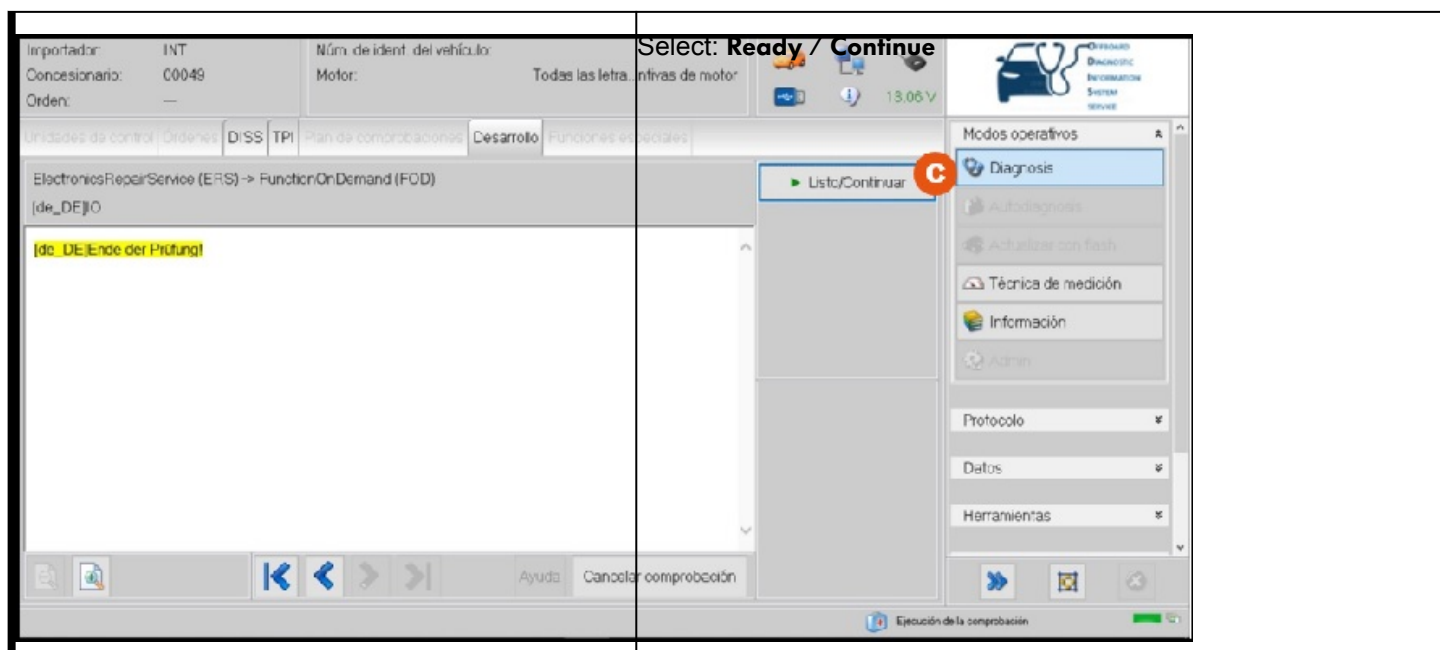

#### **After completing the reprogramming, erase the faults:**

Before completing the final CAN session, erase the faults.

Special functions>>Erase fault memory - Complete system

If necessary, follow test plans proposed by ODIS.

#### **Important information on problems during the reprogramming:**

Problem	Corrective measure
After updating the Gateway Control unit, <b>faults are generated in static/active state, such as U163600 (parking coordinator not started)</b> .	Perform a bus rest using the ODIS Service diagnosis system, at the following path: <a href="#">Leon/Formentor &gt;&gt; Diagnosable systems &gt;&gt; 0019 - Diagnosis interface for databus &gt;&gt; 0019 - Diagnosis interface for databus, Functions &gt;&gt; 0019 - Establish bus rest</a>
In the DoIP session, the program stops during fault clearing for more than 5 minutes (at 63%).	Disconnect the diagnostics head from the vehicle. ODIS is unlocked at 63% during fault clearing, allowing the session to be ended and a protocol to be sent without having to restart the program.
The headlights record the fault "C107E54: No basic setting"	Perform a basic setting of the headlights using the ODIS Service diagnosis system, at the following path: <a href="#">Diagnosable Systems &gt;&gt; 0009 - Central electronics box &gt;&gt; 0009 - Functions, Headlight range adjustment &gt;&gt; 0009 - Basic setting Headlight range adjustment</a>
A travel assist/front assist warning lights up on the instrument panel (function not currently available).	Restore Gateway 0019 functions at the following path: <a href="#">Software version management --&gt; Function clearing system (FES) --&gt; 2. Restore function&gt;&gt; 0019</a> After restoring the functions, turn the ignition off and on.
Basic settings are lost, for example, power windows, steering angle sensor).	Execute the test plan calculated by the diagnosis equipment in relation to:

	<ul style="list-style-type: none"> <li>• Basic settings</li> <li>• Disable/lock SFD protection</li> </ul>
Just after the correct update of the software, the following entry is recorded in the event memory in the databus diagnosis interface control unit (diagnosis address: 0019):  "U164300 - Ethernet reversing camera control unit - No communication"	Ignore. This event memory entry does not cause any customer claim
In certain cases, after updating the software of the CAN control units, the ignition cannot be turned off/on with the "start button".	<p>Proceed as described below.</p> <p>Remove the ignition key (radio frequency remote control) from the centre console (reader coil).</p> <ul style="list-style-type: none"> <li>• Proceed to lock the vehicle once from the outside with the radio frequency remote control and then immediately unlock it again.</li> <li>• Insert the ignition key (radio frequency remote control) into the reader coil on the centre console.</li> <li>• Switch on ignition.</li> <li>• Follow the diagnostics equipment instructions.</li> </ul> <p><b>If the claim persists (the ignition cannot be turned on/off with the "start button"):</b></p> <ul style="list-style-type: none"> <li>• Disconnect the 12 V battery</li> <li>• Wait 2 minutes. Reconnect the 12 V battery</li> <li>• Switch on ignition</li> <li>• Start the engine</li> <li>• Adapt the steering limits</li> <li>• Adapt the power windows</li> <li>• Turn the engine off</li> <li>• Switch ignition off</li> <li>• Switch ignition back on</li> <li>• Follow the diagnostics equipment instructions</li> </ul>

## Identification

### Vehicles with Digital Maintenance Plan:

Once **all** the required work has been carried out (all criteria), write down "**90T5 performed**" in <workshop note> in the text field in the Digital Maintenance Plan. Then print the full receipt for the service work and attach it to the **owner's manual**.

### Vehicles with Maintenance Plan:

Once **all** the required work has been carried out (all criteria), write down "**90T5 date/stamp**" in the "Space for workshop notes" in the Digital Maintenance Plan.