

Specified torque	Nm
Oil filler plug	15

Ensure adherence to prescribed temperature range during oil level check, if oil temperature was not within prescribed temperature range of 20 °C to 40 °C when topping up oil.

The oil temperature can be measured using temperature gauge - VAS 6519- .

If the oil temperature is not between 20 and 40 °C, the temperature must be reached by warming up or cooling down.

Oil capacity and oil specification	
Oil fill quantity of the all-wheel drive coupling	⇒ Rear propshaft and final drive; Rep. gr. 00 ; Technical data; Capacities
Oil specifications	⇒ Electronic parts catalogue

## 4.56 Tyres, including spare tyre: check condition, tread, inflation pressure, depth of tyre tread

⇒ [“4.56.1 Check age of the tyre”, page 121](#)

⇒ [“4.56.2 Checking condition of tyre”, page 122](#)

⇒ [“4.56.3 Check the tyre tread for even wear”, page 122](#)

⇒ [“4.56.4 Check depth of tread \(including spare wheel\)”, page 122](#)

⇒ [“4.56.5 Tyre pressure until MY 15 \(week 21/2015\)”, page 123](#)

⇒ [“4.56.6 Tyre pressure as of MY 16 \(week 22/2015\)”, page 132](#)



### NOTICE

All tyres and wheels (front and rear) must be of same type and size. On four-wheel drive vehicles you must also ensure that all tyres are made by the same manufacturer and have the same tread pattern.

### 4.56.1 Check age of the tyre

The age of the tyre can be determined using the “DOT” marking which specifies the date of manufacturing.



### CAUTION

We recommend not to use any tyres older than 6 years.

Example of a “DOT” marking from the 01.01.2000:

DO	.....	0 1	0 0
T	.		
		The last two digits specify the year of manufacture.	
		Week of the year	

In this example, the date of manufacture would be the first week of the year 2000.

## 4.56.2 Checking condition of tyre

Carry out the following work:

### Delivery Inspection

- Check tyres (tread and side walls) for damage and remove foreign bodies, for example nails and glass splinters, if necessary.

#### ! NOTICE

If damage is determined, always check to see if a new tyre should be fitted.

### Inspection Service

- Check tyres (tread and side walls) for damage and remove foreign bodies, for example nails and glass splinters, if necessary.
- Check tyres for erosion, one-sided tread wear, porosity on the side walls, cuts and perforations.

#### ! NOTICE

The customer must be informed of any deficiencies found.

## 4.56.3 Check the tyre tread for even wear

The wear pattern on the front tyres will indicate, for example, if toe and camber settings should be checked:

- ◆ Feathering on tread indicates incorrect toe setting.
- ◆ One-sided tread wear is mainly attributed to incorrect camber.

When wear of this nature is noticed, locate the cause by measuring the geometry of the axles (repair measure).

## 4.56.4 Check depth of tread (including spare wheel)

### Special tools and workshop equipment required

- ◆ Measuring tool - T40139-

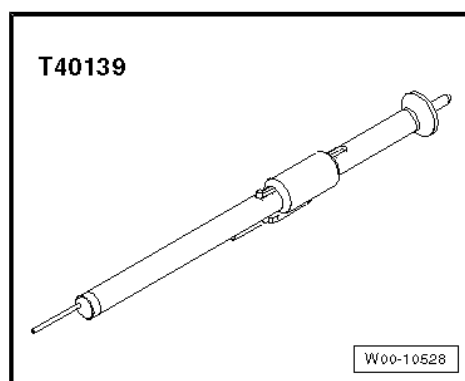

To check the tread depth of the tyres, move the sliding ring to the end in the direction of the measuring tip.

Then move the measuring tip of the tester up to the end in a tread groove and push the device evenly in the direction of the tyre until the tester makes contact with the belt of the tyre.

Then remove the tester and read-off the value on the scale with the tyre symbol.

**! NOTICE**

After a successful measurement, when removing the test device, take care that the sliding ring is not displaced. Otherwise, the measurement is faulty.

The second scale on the tester (brake symbol) can be used to determine the thickness of the brake pad.

- Minimum depth: 1.6 mm

**! NOTICE**

This figure may vary according to legislation in individual countries.

The minimum tread depth is reached when the tyres have worn down level with the 1.6 mm high tread wear indicators -arrows- positioned at intervals around the tyre.

**! NOTICE**

If the tread depth is approaching the minimum allowed depth, inform the customer.

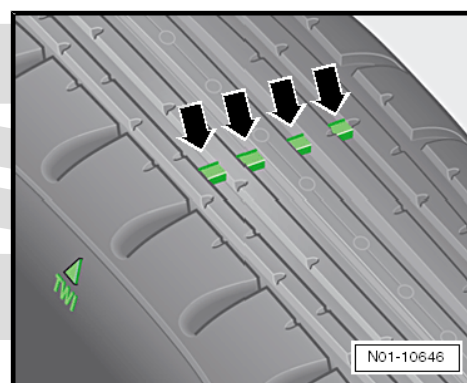

#### 4.56.5 Tyre pressure until MY 15 (week 21/2015)

Data chart Leon and Leon SC, excluding Great Britain

⇒ [page 124](#) .

Data chart Leon and Leon SC, Great Britain only ⇒ [page 125](#) .

Data chart Leon ST, excluding Great Britain ⇒ [page 127](#) .

Data chart Leon ST, Great Britain only ⇒ [page 129](#) .

**! NOTICE**

The mandatory tyre pressures for the respective model can also be found on a sticker attached to the inside of the tank flap or to the B-pillar.

Check for the presence of the inflation pressure sticker at delivery inspection.

If the inflation pressure sticker is missing, proceed as follows:

Look up the correct part number for the respective vehicle in the ⇒ [Electronic parts catalogue](#) .

Using the part number, locate the respective inflation pressures in the inflation table.

Spare wheel with standard tyres: Observe the maximum designated tyre pressure for the vehicle.

Temporary spare wheel: The tyre pressure is indicated on the tyre sidewall.

# Data chart Leon and Leon SC, excluding Great Britain

Engine	Standard wheels		Tyre pressure (kPa/bar/psi)			
	Disc wheels (wheel rims)	Tyres	Semi-charged		Full load	
			front	rear	front	rear
1.2/63 kW	6Jx15 ET43	195/65 R15	220/2.2/32	200/2.0/29	240/2.4/35	260/2.6/38
1.2/77 kW						
1.6 66 kW CR						
1.6 77 kW CR						
1.6 81 kW CR						
2.0 81 kW CR						
1.6 81 kW CR Ecomotive	6Jx15 ET43	195/65 R15	270/2.7/39	270/2.7/39	270/2.7/39	280/2.8/41
1.2/63 kW	6.5Jx16 ET46	205/55 R16	220/2.2/32	200/2.0/29	240/2.4/35	260/2.6/38
1.2/77 kW						
1.4/90 kW						
1.4/103 kW						
1.4/110 kW						
1.6 66 kW CR						
1.6 77 kW CR						
1.6 81 kW CR						
1.6 81 kW CR Ecomotive	6.5Jx16 ET46	205/55 R16	270/2.7/39	270/2.7/39	270/2.7/39	280/2.8/41
2.0 81 kW CR	6.5Jx16 ET46	205/55 R16	240/2.4/35	220/2.2/32	260/2.6/38	280/2.8/41
2.0 105 kW CR						
2.0 110 kW CR						
1.2/77 kW	7Jx17 ET49	225/45 R17	220/2.2/32	200/2.0/29	240/2.4/35	260/2.6/38
1.4/90 kW						
1.4/103 kW						
1.4/110 kW						
1.6 77 kW CR						
1.6 81 kW CR						
2.0 81 kW CR	7Jx17 ET49	225/45 R17	240/2.4/35	220/2.2/32	260/2.6/38	280/2.8/41

Engine	Standard wheels		Tyre pressure (kPa/bar/psi)			
	Disc wheels (wheel rims)	Tyres	Semi-charged		Full load	
			front	rear	front	rear
2.0 105 kW CR						
2.0 110 kW CR						
1.4/90 kW						
1.4/103 kW	7.5Jx17 ET51	225/45 R17	220/2.2/32	200/2.0/29	240/2.4/35	260/2.6/38
1.4/110 kW						
1.8/135 kW						
2.0 105 kW CR	7.5Jx17 ET51	225/45 R17	240/2.4/35	220/2.2/32	260/2.6/38	280/2.8/41
2.0 110 kW CR						
2.0 135 kW CR						
1.4/90 kW	7.5Jx18 ET51	225/40 R18	220/2.2/32	200/2.0/29	240/2.4/35	260/2.6/38
1.4/103 kW						
1.4/110 kW						
1.8/135 kW	7.5Jx18 ET51	225/40 R18	240/2.4/35	220/2.2/32	260/2.6/38	280/2.8/41
2.0 105 kW CR						
2.0 110 kW CR						
2.0 135 kW CR	7.5Jx18 ET51	225/40 R18	250/2.5/36	230/2.3/33	280/2.8/41	280/2.8/41
2.0 195 kW Cupra						
2.0 206 kW Cupra						
2.0 195 kW Cupra	7.5Jx19 ET51	235/35 R19	270/2.7/39	240/2.4/35	290/2.9/42	290/2.9/42
2.0 206 kW Cupra						

Protected by copyright. Copying for private or commercial purposes, in part or in whole, is not permitted unless authorised by SEAT S.A. SEAT S.A. does not guarantee or accept any liability with respect to the correctness of information in this document. Copyright by SEAT S.A.

#### Data chart Leon and Leon SC, Great Britain only

Engine	Standard wheels		Tyre pressure (kPa/bar/psi)			
	Disc wheels (wheel rims)	Tyres	Semi-charged		Full load	
			front	rear	front	rear
1.2/63 kW	6Jx15 ET43	195/65 R15	200/2.0/29	180/1.8/26	240/2.4/35	260/2.6/38
1.2/77 kW						

Engine	Standard wheels		Tyre pressure (kPa/bar/psi)			
	Disc wheels (wheel rims)	Tyres	Semi-charged		Full load	
			front	rear	front	rear
1.6 66 kW CR						
1.6 77 kW CR						
1.6 81 kW CR						
2.0 81 kW CR						
1.6 81 kW CR Ecomotive	6Jx15 ET43	195/65 R15	270/2.7/39	270/2.7/39	270/2.7/39	280/2.8/41
1.2/63 kW	6.5Jx16 ET46	205/55 R16	200/2.0/29	180/1.8/26	240/2.4/35	260/2.6/38
1.2/77 kW						
1.4/90 kW						
1.4/103 kW						
1.4/110 kW						
1.6 66 kW CR						
1.6 77 kW CR						
1.6 81 kW CR						
1.6 81 kW CR Ecomotive						
2.0 81 kW CR						
2.0 105 kW CR	6.5Jx16 ET46	205/55 R16	220/2.2/32	200/2.0/29	260/2.6/38	260/2.6/38
2.0 110 kW CR						
1.2/77 kW						
1.4/90 kW	7Jx17 ET49	225/45 R17	200/2.0/29	180/1.8/26	240/2.4/35	260/2.6/38
1.4/103 kW						
1.4/110 kW						
1.6 77 kW CR						
1.6 81 kW CR						
2.0 81 kW CR	7Jx17 ET49	225/45 R17	220/2.2/32	200/2.0/29	260/2.6/38	260/2.6/38
2.0 105 kW CR						
2.0 110 kW CR						
1.4/90 kW	7.5Jx17 ET51	225/45 R17	200/2.0/29	180/1.8/26	240/2.4/35	260/2.6/38
1.4/103 kW						

Engine	Standard wheels		Tyre pressure (kPa/bar/psi)			
	Disc wheels (wheel rims)	Tyres	Semi-charged		Full load	
			front	rear	front	rear
1.4/110 kW	7.5Jx17 ET51	225/45 R17	220/2.2/32	200/2.0/29	260/2.6/38	260/2.6/38
1.8/135 kW						
2.0 105 kW CR						
2.0 110 kW CR						
2.0 135 kW CR	7.5Jx17 ET51	225/45 R17	230/2.3/33	210/2.1/31	280/2.8/41	280/2.8/41
1.4/90 kW	7.5Jx18 ET51	225/40 R18	200/2.0/29	180/1.8/26	240/2.4/35	260/2.6/38
1.4/103 kW						
1.4/110 kW						
1.8/135 kW	7.5Jx18 ET51	225/40 R18	220/2.2/32	200/2.0/29	260/2.6/38	260/2.6/38
2.0 105 kW CR						
2.0 110 kW CR						
2.0 135 kW CR						
2.0 195 kW Cupra	7.5Jx18 ET51	225/40 R18	260/2.6/38	230/2.3/33	280/2.8/41	280/2.8/41
2.0 206 kW Cupra						
2.0 195 kW Cupra	7.5Jx19 ET51	235/35 R19	270/2.7/39	240/2.4/35	290/2.9/42	290/2.9/42
2.0 206 kW Cupra						

#### Data chart Leon ST, excluding Great Britain

Engine	Standard wheels		Tyre pressure (kPa/bar/psi)			
	Disc wheels (wheel rims)	Tyres	Semi-charged		Full load	
			front	rear	front	rear
1.2/63 kW	6Jx15 ET43	195/65 R15	220/2.2/32	220/2.2/32	240/2.4/35	260/2.6/38
1.2/77 kW						
1.6 66 kW CR						
1.6 77 kW CR						
1.6 81 kW CR						
2.0 81 kW CR						

Protected by copyright. Copying for private or commercial purposes, in part or in whole, is not permitted unless authorised by SEAT S.A. SEAT S.A. does not guarantee or accept any liability with respect to the correctness of information in this document. Copyright by SEAT S.A.

Engine	Standard wheels		Tyre pressure (kPa/bar/psi)			
	Disc wheels (wheel rims)	Tyres	Semi-charged		Full load	
			front	rear	front	rear
1.6 81 kW CR Ecomotive	6Jx15 ET43	195/65 R15	280/2.8/41	280/2.8/41	280/2.8/41	290/2.9/42
1.2/63 kW	6.5Jx16 ET46	205/55 R16	220/2.2/32	220/2.2/32	240/2.4/35	260/2.6/38
1.2/77 kW						
1.4/90 kW						
1.4/103 kW						
1.4/110 kW						
1.6 66 kW CR						
1.6 77 kW CR						
1.6 81 kW CR						
1.6 81 kW CR Ecomotive	6.5Jx16 ET46	205/55 R16	280/2.8/41	280/2.8/41	280/2.8/41	290/2.9/42
2.0 81 kW CR	6.5Jx16 ET46	205/55 R16	240/2.4/35	240/2.4/35	260/2.6/38	280/2.8/41
2.0 105 kW CR						
2.0 110 kW CR						
2.0 110 kW CR						
1.2/77 kW	7Jx17 ET49	225/45 R17	220/2.2/32	220/2.2/32	240/2.4/35	260/2.6/38
1.4/90 kW						
1.4/103 kW						
1.4/110 kW						
1.6 77 kW CR						
1.6 81 kW CR						
2.0 81 kW CR						
2.0 105 kW CR						
2.0 110 kW CR	7Jx17 ET49	225/45 R17	240/2.4/35	240/2.4/35	260/2.6/38	280/2.8/41
2.0 110 kW CR						
2.0 110 kW CR						
2.0 110 kW CR						
1.4/90 kW	7.5Jx17 ET51	225/45 R17	220/2.2/32	220/2.2/32	240/2.4/35	260/2.6/38
1.4/103 kW						
1.4/110 kW						
1.8/135 kW	7.5Jx17 ET51	225/45 R17	240/2.4/35	240/2.4/35	260/2.6/38	280/2.8/41
2.0 105 kW CR						
2.0 110 kW CR						

Protected by copyright. Copying for private or commercial purposes, in part or in whole, is not permitted unless authorised by SEAT S.A. SEAT S.A. does not guarantee or accept any liability with respect to the correctness of information in this document. Copyright by SEAT S.A.



Engine	Standard wheels		Tyre pressure (kPa/bar/psi)			
	Disc wheels (wheel rims)	Tyres	Semi-charged		Full load	
			front	rear	front	rear
2.0 135 kW CR	7.5Jx17 ET51	225/45 R17	250/2.5/36	250/2.5/36	280/2.8/41	280/2.8/41
1.4/90 kW	7.5Jx18 ET51	225/40 R18	220/2.2/32	220/2.2/32	240/2.4/35	260/2.6/38
1.4/103 kW						
1.4/110 kW						
1.8/135 kW	7.5Jx18 ET51	225/40 R18	240/2.4/35	240/2.4/35	260/2.6/38	280/2.8/41
2.0 105 kW CR	7.5Jx18 ET51	225/40 R18	250/2.5/36	250/2.5/36	280/2.8/41	280/2.8/41
2.0 110 kW CR						
2.0 135 kW CR						
2.0 195 kW Cupra	7.5Jx18 ET51	225/40 R18	260/2.6/38	250/2.5/36	280/2.8/41	280/2.8/41
2.0 206 kW Cupra	7.5Jx19 ET51	235/35 R19	270/2.7/39	260/2.6/38	290/2.9/42	290/2.9/42
2.0 195 kW Cupra						
2.0 206 kW Cupra						

#### Data chart Leon ST, Great Britain only

Engine	Standard wheels		Tyre pressure (kPa/bar/psi)			
	Disc wheels (wheel rims)	Tyres	Semi-charged		Full load	
			front	rear	front	rear
1.2/63 kW	6Jx15 ET43	195/65 R15	200/2.0/29	200/2.0/29	240/2.4/35	260/2.6/38
1.2/77 kW						
1.6 66 kW CR						
1.6 77 kW CR						
1.6 81 kW CR						
2.0 81 kW CR						
1.6 81 kW CR Ecomotive	6Jx15 ET43	195/65 R15	280/2.8/41	280/2.8/41	280/2.8/41	290/2.9/42
1.2/63 kW	6.5Jx16 ET46	205/55 R16	200/2.0/29	200/2.0/29	240/2.4/35	260/2.6/38
1.2/77 kW						
1.4/90 kW						

Engine	Standard wheels		Tyre pressure (kPa/bar/psi)			
	Disc wheels (wheel rims)	Tyres	Semi-charged		Full load	
			front	rear	front	rear
1.4/103 kW	6.5Jx16 ET46	205/55 R16	280/2.8/41	280/2.8/41	280/2.8/41	290/2.9/42
1.4/110 kW						
1.6 66 kW CR						
1.6 77 kW CR						
1.6 81 kW CR						
1.6 81 kW CR Ecomotive	6.5Jx16 ET46	205/55 R16	280/2.8/41	280/2.8/41	280/2.8/41	290/2.9/42
2.0 81 kW CR	6.5Jx16 ET46	205/55 R16	220/2.2/32	220/2.2/32	260/2.6/38	260/2.6/38
2.0 105 kW CR						
2.0 110 kW CR						
1.2/77 kW	7Jx17 ET49	225/45 R17	200/2.0/29	200/2.0/29	240/2.4/35	260/2.6/38
1.4/90 kW						
1.4/103 kW						
1.4/110 kW						
1.6 77 kW CR						
1.6 81 kW CR	7Jx17 ET49	225/45 R17	220/2.2/32	220/2.2/32	260/2.6/38	260/2.6/38
2.0 81 kW CR						
2.0 105 kW CR						
2.0 110 kW CR	7.5Jx17 ET51	225/45 R17	200/2.0/29	200/2.0/29	240/2.4/35	260/2.6/38
1.4/90 kW						
1.4/103 kW						
1.4/110 kW						
1.8/135 kW	7.5Jx17 ET51	225/45 R17	220/2.2/32	220/2.2/32	260/2.6/38	260/2.6/38
2.0 105 kW CR						
2.0 110 kW CR						
2.0 135 kW CR	7.5Jx17 ET51	225/45 R17	230/2.3/33	230/2.3/33	280/2.8/41	280/2.8/41
1.4/90 kW	7.5Jx18 ET51	225/40 R18	200/2.0/29	200/2.0/29	240/2.4/35	260/2.6/38
1.4/103 kW						
1.4/110 kW						

Engine	Standard wheels		Tyre pressure (kPa/bar/psi)			
	Disc wheels (wheel rims)	Tyres	Semi-charged		Full load	
			front	rear	front	rear
1.8/135 kW	7.5Jx18 ET51	225/40 R18	220/2.2/32	220/2.2/32	260/2.6/38	260/2.6/38
2.0 105 kW CR						
2.0 110 kW CR						
2.0 135 kW CR	7.5Jx18 ET51	225/40 R18	230/2.3/33	230/2.3/33	280/2.8/41	280/2.8/41
2.0 195 kW Cupra	7.5Jx18 ET51	225/40 R18	260/2.6/38	250/2.5/36	280/2.8/41	280/2.8/41
2.0 206 kW Cupra						
2.0 195 kW Cupra	7.5Jx19 ET51	235/35 R19	270/2.7/39	260/2.6/38	290/2.9/42	290/2.9/42
2.0 206 kW Cupra						



SEAT

Protected by copyright. Copying for private or commercial purposes, in part or in whole, is not permitted unless authorised by SEAT S.A. SEAT S.A does not guarantee or accept any liability with respect to the correctness of information in this document. Copyright by SEAT S.A.



## 4.56.6 Tyre pressure as of MY 16 (week 22/2015)

Data table for Leon and Leon SC ➔ [page 132](#) .

Data table for Leon ST ➔ [page 135](#) .

### NOTICE

The mandatory tyre pressures for the respective model can also be found on a sticker attached to the inside of the tank flap or to the B-pillar.

Check for the presence of the inflation pressure sticker at delivery inspection.

If the inflation pressure sticker is missing, proceed as follows:

Look up the correct part number for the respective vehicle in the ➔ [Electronic parts catalogue](#) .

Using the part number, locate the respective inflation pressures in the inflation table.

Spare wheel with standard tyres: Observe the maximum designated tyre pressure for the vehicle.

### WARNING

Depending on the vehicle, the tyre pressure can be adapted to a partial load for better driving comfort (comfort tyre pressure).

When driving with the comfort tyre pressure, fuel consumption may increase slightly.

### Data table for Leon and Leon SC

Part number - 5F0 010 000 BA-		<div>SEAT</div> <div>Leon 5F</div> <div>Protected by copyright. Copying for private or commercial purposes, in part or in whole, is not permitted unless authorised by SEAT S.A. SEAT S.A does not guarantee or accept any liability with respect to the correctness of information in this document. Copyright by SEAT S.A.</div>				
Part number - 5F0 010 000 CF-						
Part number - 5F0 010 000 CT-						
	Half payload kPa/bar/psi		Half payload, Convenience kPa/bar/psi		Full payload kPa/bar/psi	
Tyre size	front	rear	front	rear	front	rear
All <sup>1)</sup>	250/2.5/36	230/2.3/33	220/2.2/32	200/2.0/29	250/2.5/36	260/2.6/38
Emergency spare tyre	420/4.2/61					

<sup>1)</sup> Valid for all authorised wheel/tyre combinations. ➔ [Wheels and Tyres Guide](#); Rep. gr. 44 ; Wheel and tyre combinations .

Part number - 5F0 010 000 BJ-	Leon 5F					
Part number - 5F0 010 000 CG-						
Part number - 5F0 010 000 DD-						
	Half payload kPa/bar/psi		Half payload, Convenience kPa/bar/psi		Full payload kPa/bar/psi	
<b>Tyre size</b>	<b>front</b>	<b>rear</b>	<b>front</b>	<b>rear</b>	<b>front</b>	<b>rear</b>
All <sup>1)</sup>	250/2.5/36	250/2.5/36	220/2.2/32	220/2.2/32	250/2.5/36	260/2.6/38
Emergency spare tyre	420/4.2/61					

<sup>1)</sup> Valid for all authorised wheel/tyre combinations. ⇒ Wheels and Tyres Guide; Rep. gr. 44 ; Wheel and tyre combinations .

Part number - 5F0 010 000 BG-	Leon 5F					
Part number - 5F0 010 000 CH-						
Part number - 5F0 010 000 DC-						
	Half payload kPa/bar/psi		Half payload, Convenience kPa/bar/psi		Full payload kPa/bar/psi	
<b>Tyre size</b>	<b>front</b>	<b>rear</b>	<b>front</b>	<b>rear</b>	<b>front</b>	<b>rear</b>
All <sup>1)</sup>	270/2.7/39	240/2.4/35			290/2.9/42	290/2.9/42
Emergency spare tyre	420/4.2/61					

<sup>1)</sup> Valid for all authorised wheel/tyre combinations. ⇒ Wheels and Tyres Guide; Rep. gr. 44 ; Wheel and tyre combinations .

Part number - 5F0 010 000 BB-	Leon 5F					
Part number - 5F0 010 000 CJ-						
Part number - 5F0 010 000 DA-						
	Half payload kPa/bar/psi		Half payload, Convenience kPa/bar/psi		Full payload kPa/bar/psi	
<b>Tyre size</b>	<b>front</b>	<b>rear</b>	<b>front</b>	<b>rear</b>	<b>front</b>	<b>rear</b>
All <sup>1)</sup>	270/2.7/39	250/2.5/36	240/2.4/35	220/2.2/32	270/2.7/39	280/2.8/41
Emergency spare tyre	420/4.2/61					

<sup>1)</sup> Valid for all authorised wheel/tyre combinations. ⇒ Wheels and Tyres Guide; Rep. gr. 44 ; Wheel and tyre combinations .

Protected by copyright. Copying for private or commercial purposes, in part or in whole, is not permitted unless authorised by SEAT S.A. SEAT S.A. does not guarantee or accept any liability with respect to the correctness of information in this document. Copyright by SEAT S.A.



Part number - 5F0 010 000 BC-	Leon 5F					
Part number - 5F0 010 000 CK-						
Part number - 5F0 010 000 DB-						
	Half payload kPa/bar/psi		Half payload, Convenience kPa/bar/psi		Full payload kPa/bar/psi	
<b>Tyre size</b>	<b>front</b>	<b>rear</b>	<b>front</b>	<b>rear</b>	<b>front</b>	<b>rear</b>
All <sup>1)</sup>	280/2.8/41	260/2.6/38	250/2.5/36	230/2.3/33	280/2.8/41	280/2.8/41
Emergency spare tyre	420/4.2/61					

<sup>1)</sup> Valid for all authorised wheel/tyre combinations. ⇒ Wheels and Tyres Guide; Rep. gr. 44 ; Wheel and tyre combinations .

Part number - 5F0 010 000 AD-	Leon 5F					
Part number - 5F0 010 000 CL-						
Part number - 5F0 010 000 CS-						
	Half payload kPa/bar/psi		Half payload, Convenience kPa/bar/psi		Full payload kPa/bar/psi	
<b>Tyre size</b>	<b>front</b>	<b>rear</b>	<b>front</b>	<b>rear</b>	<b>front</b>	<b>rear</b>
All <sup>1)</sup>	270/2.7/39	270/2.7/39	240/2.4/35	240/2.4/35	270/2.7/39	280/2.8/41
Emergency spare tyre	420/4.2/61					

Protected by copyright. Copying for private or commercial purposes, in part or in whole, is not permitted unless authorised by SEAT S.A. SEAT S.A. does not guarantee or accept any liability with respect to the correctness of information in this document. Copyright by SEAT S.A.

<sup>1)</sup> Valid for all authorised wheel/tyre combinations. ⇒ Wheels and Tyres Guide; Rep. gr. 44 ; Wheel and tyre combinations .

Part number - 5F0 010 000 S-	Leon 5F					
Part number - 5F0 010 000 CR-						
	Half payload kPa/bar/psi		Half payload, Convenience kPa/bar/psi		Full payload kPa/bar/psi	
<b>Tyre size</b>	<b>front</b>	<b>rear</b>	<b>front</b>	<b>rear</b>	<b>front</b>	<b>rear</b>
All <sup>1)</sup>	280/2.8/41	280/2.8/41	250/2.5/36	250/2.5/36	280/2.8/41	290/2.9/42
Emergency spare tyre	420/4.2/61					

<sup>1)</sup> Valid for all authorised wheel/tyre combinations. ⇒ Wheels and Tyres Guide; Rep. gr. 44 ; Wheel and tyre combinations .

**Data table for León ST**

Part number - 5F0 010 000 BJ-	 León 5F					
Part number - 5F0 010 000 CG-						
Part number - 5F0 010 000 DD-						
	Half payload kPa/bar/psi		Half payload, Convenience kPa/bar/psi		Full payload kPa/bar/psi	
<b>Tyre size</b>	<b>front</b>	<b>rear</b>	<b>front</b>	<b>rear</b>	<b>front</b>	<b>rear</b>
All <sup>1)</sup>	250/2.5/36	250/2.5/36	220/2.2/32	220/2.2/32	250/2.5/36	260/2.6/38
Emergency spare tyre	420/4.2/61					

<sup>1)</sup> Valid for all authorised wheel/tyre combinations. ⇒ Wheels and Tyres Guide; Rep. gr. 44 ; Wheel and tyre combinations .

Part number - 5F0 010 000 BK-	 León 5F					
Part number - 5F0 010 000 CM-						
Part number - 5F0 010 000 DE-						
	Half payload kPa/bar/psi		Half payload, Convenience kPa/bar/psi		Full payload kPa/bar/psi	
<b>Tyre size</b>	<b>front</b>	<b>rear</b>	<b>front</b>	<b>rear</b>	<b>front</b>	<b>rear</b>
All <sup>1)</sup>	270/2.7/39	270/2.7/39	240/2.4/35	240/2.4/35	270/2.7/39	280/2.8/41
Emergency spare tyre	420/4.2/61					

<sup>1)</sup> Valid for all authorised wheel/tyre combinations. ⇒ Wheels and Tyres Guide; Rep. gr. 44 ; Wheel and tyre combinations .

Protected by copyright. Copying for private or commercial purposes, in part or in whole, is not permitted unless authorised by SEAT S.A. SEAT S.A does not guarantee or accept any liability with respect to the correctness of information in this document. Copyright by SEAT S.A.

Part number - 5F0 010 000 BQ-	 León 5F					
Part number - 5F0 010 000 CN-						
Part number - 5F0 010 000 DG-						
	Half payload kPa/bar/psi		Half payload, Convenience kPa/bar/psi		Full payload kPa/bar/psi	
<b>Tyre size</b>	<b>front</b>	<b>rear</b>	<b>front</b>	<b>rear</b>	<b>front</b>	<b>rear</b>
All <sup>1)</sup>	270/2.7/39	260/2.6/38			290/2.9/42	290/2.9/42
Emergency spare tyre	420/4.2/61					

<sup>1)</sup> Valid for all authorised wheel/tyre combinations. ⇒ Wheels and Tyres Guide; Rep. gr. 44 ; Wheel and tyre combinations .

Part number - 5F0 010 000 BL-	Leon 5F					
Part number - 5F0 010 000 CP-						
Part number - 5F0 010 000 DF-						
	Half payload kPa/bar/psi		Half payload, Convenience kPa/bar/psi		Full payload kPa/bar/psi	
<b>Tyre size</b>	<b>front</b>	<b>rear</b>	<b>front</b>	<b>rear</b>	<b>front</b>	<b>rear</b>
All <sup>1)</sup>	280/2.8/41	280/2.8/41	250/2.5/36	250/2.5/36	280/2.8/41	280/2.8/41
Emergency spare tyre	420/4.2/61					

<sup>1)</sup> Valid for all authorised wheel/tyre combinations. ⇒ Wheels and Tyres Guide; Rep. gr. 44 ; Wheel and tyre combinations .

Part number - 5F0 010 000 CA-	Leon 5F					
Part number - 5F0 010 000 CD-						
Part number - 5F0 010 000 DH-						
	Half payload kPa/bar/psi		Half payload, Convenience kPa/bar/psi		Full payload kPa/bar/psi	
<b>Tyre size</b>	<b>front</b>	<b>rear</b>	<b>front</b>	<b>rear</b>	<b>front</b>	<b>rear</b>
All <sup>1)</sup>	290/2.9/42	270/2.7/39	260/2.6/38	240/2.4/35	290/2.9/42	290/2.9/42
Emergency spare tyre	420/4.2/61					

<sup>1)</sup> Valid for all authorised wheel/tyre combinations. ⇒ Wheels and Tyres Guide; Rep. gr. 44 ; Wheel and tyre combinations .

Part number - 5F0 010 000 S-	Leon 5F					
Part number - 5F0 010 000 CQ-						
Part number - 5F0 010 000 CR-						
	Half payload kPa/bar/psi		Half payload, Convenience kPa/bar/psi		Full payload kPa/bar/psi	
<b>Tyre size</b>	<b>front</b>	<b>rear</b>	<b>front</b>	<b>rear</b>	<b>front</b>	<b>rear</b>
All <sup>1)</sup>	280/2.8/41	280/2.8/41	250/2.5/36	250/2.5/36	280/2.8/41	290/2.9/42
Emergency spare tyre	420/4.2/61					

<sup>1)</sup> Valid for all authorised wheel/tyre combinations. ⇒ Wheels and Tyres Guide; Rep. gr. 44 ; Wheel and tyre combinations .



Part number - 000 071 801 AK-		Leon 5F				
	Half payload kPa/bar/psi		Half payload, Convenience kPa/bar/psi		Full payload kPa/bar/psi	
<b>Tyre size</b>	<b>front</b>	<b>rear</b>	<b>front</b>	<b>rear</b>	<b>front</b>	<b>rear</b>
All <sup>1)</sup>	270/2.7/39	240/2.4/35	-	-	290/2.9/42	290/2.9/42
Emergency spare tyre	420/4.2/61					

<sup>1)</sup> Valid for all authorised wheel/tyre combinations. ⇒ Wheels and Tyres Guide; Rep. gr. 44 ; Wheel and tyre combinations .

Part number - 5F0 071 801-		Leon 5F				
	Half payload kPa/bar/psi		RACETRACK kPa/bar/psi		Full payload kPa/bar/psi	
<b>Tyre size</b>	<b>front</b>	<b>rear</b>	<b>front</b>	<b>rear</b>	<b>front</b>	<b>rear</b>
All <sup>1)</sup>	270/2.7/39	240/2.4/35	220/2.2/32	220/2.2/32	290/2.9/42	290/2.9/42
Emergency spare tyre	420/4.2/61					

<sup>1)</sup> Valid for all authorised wheel/tyre combinations. ⇒ Wheels and Tyres Guide; Rep. gr. 44 ; Wheel and tyre combinations .

## 4.57 Wheel securing bolts: Tighten to specified torque

### At the delivery inspection

- ◆ Loosen / tighten the anti-theft wheel bolts ⇒ [page 137](#) .
- ◆ Tightening wheel bolts ⇒ [page 138](#) .
- ◆ Install wheel centre trim, wheel bolt cover caps and wheel cover ⇒ [page 138](#) .

### Loosen / tighten the anti-theft wheel bolts.

#### NOTICE

To loosen or tighten the anti-theft wheel bolts, you need a special adapter that is part of the on-board tools.

You are not allowed to not use an impact screwdriver to loosen the anti-theft wheel bolts (bolts with lock).

If there is no adapter in the vehicle for tightening / loosening the anti-theft wheel bolts, use the respective main kit for the wheel bolts.

Protec... authorised by SEAT S.A. SEAT S.A does not guarantee or accept any liability with respect to the correctness of information in this document. Copyright by SEAT S.A.

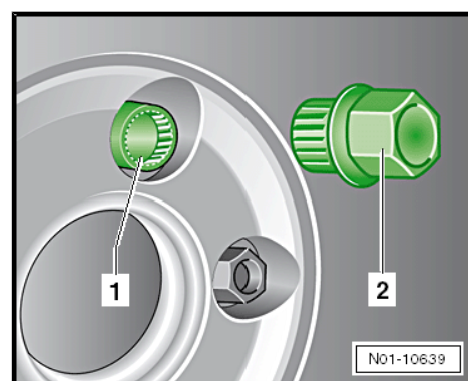

### Special tools and workshop equipment required